

# STAINLESS STEEL T CONDUIT BODIES

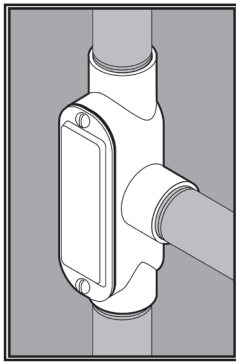

## APPLICATION

- Designed to make 90° bends, change the route of conduit, and/or to make wiring pulls and connections
- Flat back design provides extra wiring capacity
- Form 8
- Offered in seven configurations: C, LB, LL, LR, T, TB, X
- Supplied complete with cover, gasket and Type 316 SS screws
- Manufactured in stainless steel to help prevent corrosion
- Can be installed using ordinary hand tools and require little maintenance or repair
- Provided in a bright, polished finish that does not require touch up or painting

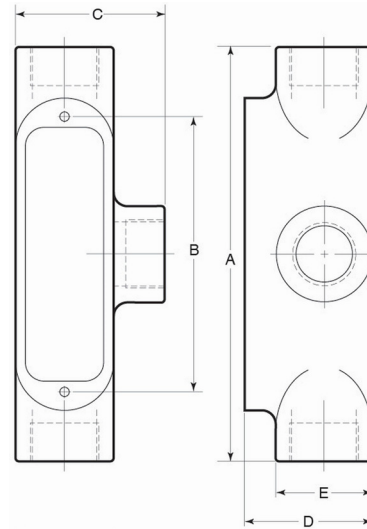

## PRODUCT DETAILS

### Material:

- Body: CF8M (316 SS)
- Cover, Screws: 316 SS
- Gasket: Neoprene

### Standards:

ASTM A351, ASTM A240,  
ASTM F593

### Country of Origin:

100% Made in USA

### UL File Number:

QCIT.E300676  
(Standard 514A)

### Canada UL File Number:

DWTT7.E300676  
(Standard 514A)

Part Number	Conduit Size	Weight/ Each (lbs.)	Dimension (in.)				
			A	B	C	D	E
7050T	½ in.	2	5.56	3.50	2.00	1.75	1.19
7075T	¾ in.	3	6.61	4.31	2.50	2.00	1.50
7100T	1 in.	4	7.53	5.00	2.70	2.31	1.75
7125T	1-¼ in.	5	8.75	6.00	3.25	2.50	2.13
7150T	1-½ in.	6	9.37	6.56	3.53	2.75	2.31
7200T	2 in.	9	11.50	8.50	4.13	3.38	2.75
7300T	3 in.	19	15.00	11.25	5.75	4.63	4.00
7400T	4 in.	29	18.25	13.75	7.13	5.44	5.13

